

# Notice of variation and consolidation with introductory note

**The Environmental Permitting (England & Wales) Regulations 2016**

---

Hazardous Waste Management Limited

Four Dell Waste Facility  
Poles Lane  
Otterbourne  
Winchester  
Hampshire  
SO21 2DY

**Variation application number**

EPR/JP3890VC/V006

**Permit number**

EPR/JP3890VC

# Four Dell Waste Facility

## Permit number EPR/JP3890VC

### Introductory note

#### This introductory note does not form a part of the notice

Under the Environmental Permitting (England & Wales) Regulations 2016 (schedule 5, part 1, paragraph 19) a variation may comprise a consolidated permit reflecting the variations and a notice specifying the variations included in that consolidated permit.

Schedule 1 of the notice specifies the conditions that have been varied and schedule 2 comprises a consolidated permit which reflects the variations being made. Only the variations specified in schedule 1 are subject to a right of appeal.

Four Dell Waste Facility is located at Four Dell Farm, Poles Lane, Otterbourne, Winchester, Hampshire, SO21 2DY (National Grid Reference SU 45470 24358). The site is situated near a number of receptors, the closest being a residential property located within 100m of the site boundary.

The treatment facility processes soils, soil substrates and road planings from a number of sources, both hazardous and non-hazardous, with the intention of producing inert soil aggregate products and hazardous road planings to be used under Regulatory Position Statement 075. The maximum annual tonnage of waste to be accepted at the site for treatment and transfer will not exceed 75,000 tonnes per annum, with 35,000 tonnes dedicated to hazardous waste treatment and storage activities and 40,000 tonnes being dedicated to non-hazardous waste treatment and storage activities.

There are no point source emissions from the site. The process will involve the treatment of wastes via a soil washing facility which is an enclosed process. All wastes will be loaded onto a hopper, which then passes the material onto an enclosed conveyor belt for loading into the system. Soils and soil substrates are processed in the soil washer using water, however road planings will be processed through the system without the use of water. All water utilised in the process will be cleaned and reused within the process. If it is not possible to reuse the water, the water will be removed from site via a tanker for disposal at authorised facilities.

All pre and post storage of materials will be undertaken outside on an impermeable surface with sealed drainage. All wastes will be stored in designated bays and will be kept sheeted, except when processing, to prevent generation of dust. Water from site drainage will be pumped into holding tanks to be used in the treatment process. All hazardous wastes, products, filter cakes and associated process waters will be stored and kept separate from non-hazardous wastes, products filters cakes, surface water and process waters.

This variation adds an additional 5.3 Part A(1)(a)(ii) activity off screening off road planings, which will be conducted through the log washer, without the use of water. This variation also consolidates variation V004, V005 and V006. It also aligns the waste codes listed in the waste tables with the activities they are associated with and corrects the soil washing activity to 5.3 Part A(1)(a)(vi) from 5.3 Part A(1)(a)(ii).

The schedules specify the changes made to the permit.

The status log of a permit sets out the permitting history, including any changes to the permit reference number.

Status log of the permit		
Description	Date	Comments
Application received EPR/BP3191SZ/A001	Issued 03/11/2008	Application for Standard Rules SR2008No11 75kte inert and excavation waste transfer station.
Application EPR/BP3191SZ/V002 (Variation)	Issued 26/05/2010	Variation to change a bespoke waste operation to add a hazardous waste treatment operation.

<b>Status log of the permit</b>		
<b>Description</b>	<b>Date</b>	<b>Comments</b>
Application EPR/JP3890VC/T001 (full transfer of permit EPR/BP3191SZ)	Issued 30/07/2010	Application to transfer the permit in full to Hazardous Waste Management Limited.
Application EPR/JP3890VC/V002 (Variation)	17/02/2012	Application to amend the companies registered office details and add 2 waste codes.
Application EPR/JP3890VC/V002 Determined	29/02/2012	Varied permit issued.
Application EPR/JP3890VC/V003 (Variation)	30/08/2013	Application withdrawn 06/11/2013.
Application EPR/JP3890VC/V004 (Variation and consolidation)	Duly made 11/08/2015	Application to add a hazardous waste soil washing facility and update the permit to modern conditions.
Variation determined EPR/JP3890VC (Billing reference: LP3433RS)	24/09/2015	Varied permit issued in modern condition format.
Application EPR/JP3890VC/V005	Duly made 05/05/2016	Application to add eight waste codes to washing facility.
Variation determined EPR/JP3890VC	18/07/2016	Varied permit issued.
Application EPR/JP3890VC/V006 (Variation and consolidation)	Duly made 27/07/2017	Application to grade by size hazardous and non-hazardous bituminous road planings utilising the existing equipment.
Request for further information	12/10/2017 09/11/2017	Responses to Schedule 5 Notice dated 05/10/2017.
Request for further information	21/11/2017	Email detailing the equipment cleaning procedure.
Variation determined EPR/JP3890VC (Billing reference: KP3639DL)	28/11/2017	Varied permit issued.

End of introductory note

# Notice of variation and consolidation

## The Environmental Permitting (England and Wales) Regulations 2016

The Environment Agency in exercise of its powers under regulation 20 of the Environmental Permitting (England and Wales) Regulations 2016 varies

### Permit number

EPR/JP3890VC

### Issued to

**Hazardous Waste Management Limited** (“the operator”)

whose registered office is

**Otterbourne Farm  
Kiln Lane  
Otterbourne  
Winchester  
Hampshire  
SO21 2EN**

company registration number 06821901

to operate a regulated facility at

**Four Dell Waste Facility  
Poles Lane  
Otterbourne  
Winchester  
Hampshire  
SO21 2DY**

to the extent set out in the schedules.

The notice shall take effect from 28 November 2017.

Name	Date
Nathan Price	28 November 2017

Authorised on behalf of the Environment Agency

## **Schedule 1**

Activities table S1.1, as referenced by conditions; 1.2.1, 1.3.1, 2.1.1, 2.1.2, 2.3.1, 2.3.6, 3.1.2, 4.2.2 has been amended.

Operating techniques table S1.2, as referenced in conditions; 2.3.1 and 2.3.2 has been amended.

Waste tables; S2.1, S2.2, S2.3, S2.4, S2.5 and S2.6, as referenced in condition 2.3.3 (a) have been amended.

Improvement programme requirements table S1.3, as referenced in condition 2.4.1 has been amended.

Annual production/treatment, table S4.2, as referenced in condition 4.2.2 (b) has been amended.

Condition 4.2.2 (a) has been added.

Pre-operational measures, table S1.4, as referenced in condition 2.5 has been removed, as has condition 2.5.

## **Schedule 2 – consolidated permit**

Consolidated permit issued as a separate document.

# Permit

## The Environmental Permitting (England and Wales) Regulations 2016

### Permit number

**EPR/JP3890VC**

This is the consolidated permit referred to in the variation and consolidation notice for application EPR/JP3890VC/V006 authorising,

**Hazardous Waste Management Limited** (“the operator”),

whose registered office is

**Otterbourne Farm  
Kiln Lane  
Otterbourne  
Winchester  
Hampshire  
SO21 2EN**

company registration number 06821901

to operate an installation at

**Four Dell Waste Facility  
Poles Lane  
Otterbourne  
Winchester  
Hampshire  
SO21 2DY**

to the extent authorised by and subject to the conditions of this permit.

<b>Name</b>	<b>Date</b>
<b>Nathan Price</b>	<b>28 November 2017</b>

Authorised on behalf of the Environment Agency

# Conditions

## 1 Management

### 1.1 General management

1.1.1 The operator shall manage and operate the activities:

- (a) in accordance with a written management system that identifies and minimises risks of pollution, including those arising from operations, maintenance, accidents, incidents, non-conformances, closure and those drawn to the attention of the operator as a result of complaints; and
- (b) using sufficient competent persons and resources.

1.1.2 Records demonstrating compliance with condition 1.1.1 shall be maintained.

1.1.3 Any person having duties that are or may be affected by the matters set out in this permit shall have convenient access to a copy of it kept at or near the place where those duties are carried out.

1.1.4 The operator shall comply with the requirements of an approved competence scheme.

### 1.2 Energy efficiency

1.2.1 For the following activities referenced in schedule 1, table S1.1, AR1 to AR6, the operator shall:

- (a) take appropriate measures to ensure that energy is used efficiently in the activities;
- (b) review and record at least every four years whether there are suitable opportunities to improve the energy efficiency of the activities; and
- (c) take any further appropriate measures identified by a review.

### 1.3 Efficient use of raw materials

1.3.1 For the following activities referenced in schedule 1, table S1.1, AR1 to AR6, the operator shall:

- (a) take appropriate measures to ensure that raw materials and water are used efficiently in the activities;
- (b) maintain records of raw materials and water used in the activities;
- (c) review and record at least every four years whether there are suitable alternative materials that could reduce environmental impact or opportunities to improve the efficiency of raw material and water use; and
- (d) take any further appropriate measures identified by a review.

### 1.4 Avoidance, recovery and disposal of wastes produced by the activities

1.4.1 The operator shall take appropriate measures to ensure that:

- (a) the waste hierarchy referred to in Article 4 of the Waste Framework Directive is applied to the generation of waste by the activities; and
- (b) any waste generated by the activities is treated in accordance with the waste hierarchy referred to in Article 4 of the Waste Framework Directive; and
- (c) where disposal is necessary, this is undertaken in a manner which minimises its impact on the environment.

- 1.4.2 The operator shall review and record at least every four years whether changes to those measures should be made and take any further appropriate measures identified by a review.

## **2 Operations**

### **2.1 Permitted activities**

- 2.1.1 The operator is only authorised to carry out the activities specified in schedule 1 table S1.1 (the “activities”).
- 2.1.2 For the following activities referenced in schedule 1, table S1.1, AR1 to AR6, waste authorised by this permit shall be clearly distinguished from any other waste on the site.

### **2.2 The site**

- 2.2.1 The activities shall not extend beyond the site, being the land shown edged in green on the site plan at schedule 7 to this permit.

### **2.3 Operating techniques**

- 2.3.1 For the following activities referenced in schedule 1, table S1.1, AR1 to AR6, the activities shall, subject to the conditions of this permit, be operated using the techniques and in the manner described in the documentation specified in schedule 1, table S1.2, unless otherwise agreed in writing by the Environment Agency.
- 2.3.2 If notified by the Environment Agency that the activities are giving rise to pollution, the operator shall submit to the Environment Agency for approval within the period specified, a revision of any plan or other documentation (“plan”) specified in schedule 1, table S1.2 or otherwise required under this permit which identifies and minimises the risks of pollution relevant to that plan, and shall implement the approved revised plan in place of the original from the date of approval, unless otherwise agreed in writing by the Environment Agency.
- 2.3.3 Waste shall only be accepted if:
- (a) it is of a type and quantity listed in schedule 2 tables S2.1, S2.2, S2.3, S2.4, S2.5, S2.6; and
  - (b) it conforms to the description in the documentation supplied by the producer and holder.
- 2.3.4 The operator shall ensure that where waste produced by the activities is sent to a relevant waste operation, that operation is provided with the following information, prior to the receipt of the waste:
- (a) the nature of the process producing the waste;
  - (b) the composition of the waste;
  - (c) the handling requirements of the waste;
  - (d) the hazardous property associated with the waste, if applicable; and
  - (e) the waste code of the waste.
- 2.3.5 The operator shall ensure that where waste produced by the activities is sent to a landfill site, it meets the waste acceptance criteria for that landfill.

### **Hazardous waste storage and treatment**

- 2.3.6 Hazardous waste shall not be mixed, either with a different category of hazardous waste or with other waste, substances or materials, unless it is authorised by schedule 1 table S1.1 and appropriate measures are taken.

### **2.4 Improvement programme**



- 2.4.1 The operator shall complete the improvements specified in schedule 1 table S1.3 by the date specified in that table unless otherwise agreed in writing by the Environment Agency.
- 2.4.2 Except in the case of an improvement which consists only of a submission to the Environment Agency, the operator shall notify the Environment Agency within 14 days of completion of each improvement.

### **3 Emissions and monitoring**

#### **3.1 Emissions to water, air or land**

- 3.1.1 The limits given in schedule 3 shall not be exceeded.
- 3.1.2 For the following activities referenced in schedule 1, table S1.1, AR1 to AR6, periodic monitoring shall be carried out at least once every 5 years for groundwater and 10 years for soil, unless such monitoring is based on a systematic appraisal of the risk of contamination.

#### **3.2 Emissions of substances not controlled by emission limits**

- 3.2.1 Emissions of substances not controlled by emission limits (excluding odour) shall not cause pollution. The operator shall not be taken to have breached this condition if appropriate measures, including, but not limited to, those specified in any approved emissions management plan, have been taken to prevent or where that is not practicable, to minimise, those emissions.
- 3.2.2 The operator shall:
- (a) if notified by the Environment Agency that the activities are giving rise to pollution, submit to the Environment Agency for approval within the period specified, an emissions management plan which identifies and minimises the risks of pollution from emissions of substances not controlled by emission limits;
  - (b) implement the approved emissions management plan, from the date of approval, unless otherwise agreed in writing by the Environment Agency.
- 3.2.3 All liquids in containers, whose emission to water or land could cause pollution, shall be provided with secondary containment, unless the operator has used other appropriate measures to prevent or where that is not practicable, to minimise, leakage and spillage from the primary container.

#### **3.3 Odour**

- 3.3.1 Emissions from the activities shall be free from odour at levels likely to cause pollution outside the site, as perceived by an authorised officer of the Environment Agency, unless the operator has used appropriate measures, including, but not limited to, those specified in any approved odour management plan, to prevent or where that is not practicable to minimise the odour.
- 3.3.2 The operator shall:
- (a) if notified by the Environment Agency that the activities are giving rise to pollution outside the site due to odour, submit to the Environment Agency for approval within the period specified, an odour management plan which identifies and minimises the risks of pollution from odour;
  - (b) implement the approved odour management plan, from the date of approval, unless otherwise agreed in writing by the Environment Agency.

#### **3.4 Noise and vibration**

- 3.4.1 Emissions from the activities shall be free from noise and vibration at levels likely to cause pollution outside the site, as perceived by an authorised officer of the Environment Agency, unless the operator has used appropriate measures, including, but not limited to, those specified in any

approved noise and vibration management plan to prevent or where that is not practicable to minimise the noise and vibration.

### **3.5 Monitoring**

- 3.5.1 The operator shall, unless otherwise agreed in writing by the Environment Agency, undertake the monitoring specified in the following tables in schedule 3 to this permit:
- (a) ambient air monitoring specified in table S3.1.
- 3.5.2 The operator shall maintain records of all monitoring required by this permit including records of the taking and analysis of samples, instrument measurements (periodic and continual), calibrations, examinations, tests and surveys and any assessment or evaluation made on the basis of such data.
- 3.5.3 Monitoring equipment, techniques, personnel and organisations employed for the emissions monitoring programme and the environmental or other monitoring specified in condition 3.5.1 shall have either MCERTS certification or MCERTS accreditation (as appropriate), where available, unless otherwise agreed in writing by the Environment Agency.
- 3.5.4 Permanent means of access shall be provided to enable sampling/monitoring to be carried out in relation to the emission points specified in schedule 3 tables S3.1, unless otherwise agreed in writing by the Environment Agency.

### **3.6 Pests**

- 3.6.1 The activities shall not give rise to the presence of pests which are likely to cause pollution, hazard or annoyance outside the boundary of the site. The operator shall not be taken to have breached this condition if appropriate measures, including, but not limited to, those specified in any approved pests management plan, have been taken to prevent or where that is not practicable, to minimise the presence of pests on the site.
- 3.6.2 The operator shall:
- (a) if notified by the Environment Agency, submit to the Environment Agency for approval within the period specified, a pests management plan which identifies and minimises risks of pollution from pests;
  - (b) implement the pests management plan, from the date of approval, unless otherwise agreed in writing by the Environment Agency.

## **4 Information**

### **4.1 Records**

- 4.1.1 All records required to be made by this permit shall:
- (a) be legible;
  - (b) be made as soon as reasonably practicable;
  - (c) if amended, be amended in such a way that the original and any subsequent amendments remain legible, or are capable of retrieval; and
  - (d) be retained, unless otherwise agreed in writing by the Environment Agency, for at least 6 years from the date when the records were made, or in the case of the following records until permit surrender:
    - (i) off-site environmental effects; and
    - (ii) matters which affect the condition of the land and groundwater.

4.1.2 The operator shall keep on site all records, plans and the management system required to be maintained by this permit, unless otherwise agreed in writing by the Environment Agency.

## 4.2 Reporting

4.2.1 The operator shall send all reports and notifications required by the permit to the Environment Agency using the contact details supplied in writing by the Environment Agency.

4.2.2 For the following activities referenced in schedule 1, table S1.1, AR1 to AR6, a report or reports on the performance of the activities over the previous year shall be submitted to the Environment Agency by 31 January (or other date agreed in writing by the Environment Agency) each year. The report(s) shall include as a minimum:

- (a) a review of the results of the monitoring and assessment carried out in accordance with the permit including an interpretive review of that data;
- (b) the annual production /treatment data set out in schedule 4 table S4.2; and
- (c) the performance parameters set out in schedule 4 table S4.3 using the forms specified in table S4.4 of that schedule.

4.2.3 Within 28 days of the end of the reporting period the operator shall, unless otherwise agreed in writing by the Environment Agency, submit reports of the monitoring and assessment carried out in accordance with the conditions of this permit, as follows:

- (a) in respect of the parameters and emission points specified in schedule 4 table S4.1;
- (b) for the reporting periods specified in schedule 4 table S4.1 and using the forms specified in schedule 4 table S4.4 ; and
- (c) giving the information from such results and assessments as may be required by the forms specified in those tables.

4.2.4 The operator shall, unless notice under this condition has been served within the preceding four years, submit to the Environment Agency, within six months of receipt of a written notice, a report assessing whether there are other appropriate measures that could be taken to prevent, or where that is not practicable, to minimise pollution.

4.2.5 Within 1 month of the end of each quarter, the operator shall submit to the Environment Agency using the form made available for the purpose, the information specified on the form relating to the site and the waste accepted and removed from it during the previous quarter.

## 4.3 Notifications

4.3.1 In the event:

- (a) that the operation of the activities gives rise to an incident or accident which significantly affects or may significantly affect the environment, the operator must immediately—
  - (i) inform the Environment Agency,
  - (ii) take the measures necessary to limit the environmental consequences of such an incident or accident, and
  - (iii) take the measures necessary to prevent further possible incidents or accidents;
- (b) of a breach of any permit condition the operator must immediately—
  - (i) inform the Environment Agency, and
  - (ii) take the measures necessary to ensure that compliance is restored within the shortest possible time;

- (c) of a breach of permit condition which poses an immediate danger to human health or threatens to cause an immediate significant adverse effect on the environment, the operator must immediately suspend the operation of the activities or the relevant part of it until compliance with the permit conditions has been restored.

4.3.2 Any information provided under condition 4.3.1 (a)(i), or 4.3.1 (b)(i) where the information relates to the breach of a limit specified in the permit, shall be confirmed by sending the information listed in schedule 5 to this permit within the time period specified in that schedule.

4.3.3 The Environment Agency shall be notified within 14 days of the occurrence of the following matters, except where such disclosure is prohibited by Stock Exchange rules:

Where the operator is a registered company:

- (a) any change in the operator's trading name, registered name or registered office address; and
- (b) any steps taken with a view to the operator going into administration, entering into a company voluntary arrangement or being wound up.

Where the operator is a corporate body other than a registered company:

- (a) any change in the operator's name or address; and
- (b) any steps taken with a view to the dissolution of the operator.

In any other case:

- (a) the death of any of the named operators (where the operator consists of more than one named individual);
- (b) any change in the operator's name(s) or address(es); and
- (c) any steps taken with a view to the operator, or any one of them, going into bankruptcy, entering into a composition or arrangement with creditors, or, in the case of them being in a partnership, dissolving the partnership.

4.3.4 Where the operator proposes to make a change in the nature or functioning, or an extension of the activities, which may have consequences for the environment and the change is not otherwise the subject of an application for approval under the Regulations or this permit:

- (a) the Environment Agency shall be notified at least 14 days before making the change; and
- (b) the notification shall contain a description of the proposed change in operation.

4.3.5 The Environment Agency shall be given at least 14 days notice before implementation of any part of the site closure plan.

## **4.4 Interpretation**

4.4.1 In this permit the expressions listed in schedule 6 shall have the meaning given in that schedule.

4.4.2 In this permit references to reports and notifications mean written reports and notifications, except where reference is made to notification being made "immediately", in which case it may be provided by telephone.

# Schedule 1 – Operations

Table S1.1 activities			
Activity reference	Activity listed in Schedule 1 of the EP Regulations	Description of specified activity and WFD Annex I and II operations	Limits of specified activity and waste types
AR1	Section 5.3 A(1)(a)(vi) - Recovery of hazardous waste with a capacity exceeding 10 tonnes per day involving recycling or reclamation of inorganic materials other than metals or metal compounds.	Treatment of hazardous waste for the purpose of producing soils and aggregates.  <b>R5:</b> Recycling/reclamation of other inorganic compounds.	Treatment operations shall be limited to physical and chemical washing of hazardous soils and screening of hazardous road planings (by-passing the washing process). Treatment of hazardous soil washing water, to reuse within the facility or removal offsite for recovery or disposal, including sludge generated in the treatment process. All process waters are to be stored in an impermeable bund. Limited to waste types and quantities as specified in Table S2.1.
AR2	Section 5.3 A(1)(a)(vi) - Recovery of hazardous waste with a capacity exceeding 10 tonnes per day involving recycling or reclamation of inorganic materials other than metals or metal compounds.	Treatment of hazardous waste road planings for the purpose of recovery.  <b>R5:</b> Recycling/reclamation of other inorganic compounds.	From receipt of waste for treatment to storage of treated waste for off-site transfer. Treatment operations shall be limited to the screening of hazardous road planings (by-passing the washing process). Limited to waste types and quantities as specified in Table S2.2 for the screening of road planings.
AR3	Section 5.6 A(1)(a) - Temporary storage of hazardous waste with a total capacity exceeding 50 tonnes pending any of the activities listed in Sections 5.1, 5.2, 5.3.	Storage of hazardous waste at the facility prior to treatment or off-site transfer.  <b>R13:</b> Storage of waste pending any of the operations numbered R1 to R12 (excluding temporary storage, pending collection, on the site where it is produced).	Reception and storage of hazardous wastes prior to treatment or transfer. All storage must take place within enclosed (sheeted) bays and on an impermeable surface with sealed drainage. Storage of hazardous and non-hazardous wastes pending treatment or transfer shall not exceed a combined total of 5,000 tonnes at any one time. Limited to waste types as specified in Table S2.1, S2.2 and S2.3.

<b>Table S1.1 activities</b>			
<b>Activity reference</b>	<b>Activity listed in Schedule 1 of the EP Regulations</b>	<b>Description of specified activity and WFD Annex I and II operations</b>	<b>Limits of specified activity and waste types</b>
<b>Directly Associated Activity</b>			
AR4	Processed soil and road planings storage.	Storage of soil and road planing aggregates post treatment.	Storage of materials to be undertaken on an impermeable surface with appropriate containment (sheeting) and sealed drainage.
AR5	Bulking of recyclable wastes recovered as an incidental part of the recovery of hazardous soils and road planings for the purposes of recovering aggregates.	<b>R4</b> - Recycling/ reclamation of metals and metal compounds. <b>R5</b> - Recycling/ reclamation of other inorganic substances. <b>R13</b> – Storage of wastes pending removal off site.	Storage of materials to be undertaken on an impermeable surface with appropriate containment (sheeting) and sealed drainage. Waste types as specified in Table S2.1 and Table S2.2.
AR6	Surface water collection and storage.	Collection and storage of surface water.	From the collection of surface water to reuse within the soil washing process or for removal off site for recovery or disposal.
<b>Activity reference</b>	<b>Description of activities for waste operations</b>	<b>Limits of activities</b>	
AR7	<b>R5:</b> Recycling/reclamation of other inorganic compounds. <b>R13:</b> Storage of waste pending any of the operations numbered R1 to R12 (excluding temporary storage, pending collection, on the site where it is produced).	<p>Treatment of non-hazardous waste for the purposes of producing soils and aggregates.</p> <p>Treatment operations shall be limited to washing and screening of non-hazardous soils and screening of non-hazardous road planings (bypassing the washing process).</p> <p>Treatment of non-hazardous soil washing water, to reuse within the facility or removal offsite for recovery or disposal, including sludge generated in the treatment process. All process waters are to be stored in an impermeable bund.</p> <p>All storage must take place within enclosed (sheeted) bays and on an impermeable surface with sealed drainage.</p> <p>All process waters are to be stored within an impermeable bunded area.</p> <p>Storage of hazardous and non-hazardous wastes pending treatment or transfer shall not exceed a combined total of 5,000 tonnes at any one time.</p> <p>Treatment limited to waste types and quantities as specified in Table 2.4 for soil washing and Table S2.5 for screening of road planings.</p> <p>Storage for bulking and transfer limited to waste types and quantities as specified in Table S2.6.</p>	

<b>Table S1.2 Operating techniques</b>		
<b>Description</b>	<b>Parts</b>	<b>Date Received</b>
Application EPR/JP3890VC/V004	Best Available Techniques Assessment dated July 2015, <ul style="list-style-type: none"> <li>• Section 5.0 – Waste Storage Procedures;</li> <li>• Section 6.0 – Waste Treatment Procedures</li> <li>• Section 7.0 – Emissions Control;</li> <li>• Section 8.0 – Emissions Monitoring;;</li> <li>• Section 9.3 – Emergency Procedures; and</li> <li>• Section 12.0 – Closure.</li> </ul>	17/07/2015
Application EPR/JP3890VC/V006	Operating Techniques, July 2017 <ul style="list-style-type: none"> <li>• Section 3.0 – Proposed Activity, excluding section 3.5 Permitted Waste Types and Quantities</li> <li>• Section 4.0 – Waste Acceptance Procedures</li> <li>• Section 5.0 – Site Security</li> <li>• Section 6.0 – Record Keeping</li> <li>• Section 8.0 – Management</li> <li>• Section 9.0 – Energy and Resources</li> </ul> Environmental Risk Assessment dated July 2017 <ul style="list-style-type: none"> <li>• Appendix A, Table A1 – Odour Risk Assessment and Management Plan;</li> <li>• Appendix A, Table A2 – Noise And Vibration Risk Assessment and Management Plan;</li> <li>• Appendix A, Table A3 – Fugitive Risk Assessment and Management Plan;</li> <li>• Appendix A, Table A4 – Accidents and Incidents Risk Assessment and Management Plan; and</li> <li>• Appendix B – Emissions Monitoring Plan</li> </ul>	27/07/2017
Email Response 21/11/2017	Equipment cleaning procedure.	21/11/2017

<b>Table S1.3 Improvement programme requirements</b>		
<b>Reference</b>	<b>Requirement</b>	<b>Date</b>
1	<p>The operator shall provide a written review of the odour management techniques at the site. The review shall include but not be limited to:</p> <ul style="list-style-type: none"> <li>• The suitability of waste codes with regards to odour potential;</li> <li>• A review of the suitability of current odour control techniques;</li> <li>• A review of the odour management plan; and</li> <li>• Proposals for any additional abatement equipment and/or management techniques to be employed at the site to control odour from the facility.</li> </ul> <p>Upon receipt of the Environment Agency’s written agreement to the findings of the odour management review, the operator shall implement any agreed changes within a timescale to be agreed with the Environment Agency.</p> <p>The Odour Management Plan shall be revised to take account of any changes and agreed in writing with the Environment Agency.</p>	Complete

<b>Table S1.3 Improvement programme requirements</b>		
<b>Reference</b>	<b>Requirement</b>	<b>Date</b>
2	<p>The operator shall provide a written review of the dust management techniques at the site. The review shall include but not be limited to:</p> <ul style="list-style-type: none"> <li>• A review of the suitability of current infrastructure to control dust emissions;</li> <li>• A review of dust management techniques;</li> <li>• A review of the dust management plan; and</li> <li>• Proposals for any additional abatement equipment and management techniques to be employed at the site to control dust from the facility.</li> </ul> <p>Upon receipt of the Environment Agency's written agreement to the findings of the dust management review, the operator shall implement any agreed changes within a timescale to be agreed with the Environment Agency.</p> <p>The Dust Management Plan shall be revised to take account of any changes and agreed in writing with the Environment Agency.</p>	Complete



## Schedule 2 – Waste types, raw materials and fuels

<b>Table S2.1 Permitted waste types and quantities for hazardous soil washing (Activity AR1)</b>	
<b>Maximum quantity</b>	Total amount of hazardous and non-hazardous waste to be treated is limited to 300 tonnes per day (combined total between activities authorised in Tables S2.1 and S2.2). Total amount of hazardous waste to be accepted annually is limited to 35,000 tonnes per year.
<b>Limits</b>	Wastes shall not have a noticeable smell of hydrocarbons, including petrol and oils.
<b>Waste code</b>	<b>Description</b>
<b>12</b>	<b>WASTES FROM SHAPING AND PHYSICAL AND MECHANICAL SURFACE TREATMENT OF METALS AND PLASTICS</b>
<b>12 01</b>	<b>waste from shaping and physical and mechanical surface treatment of metals and plastics</b>
12 01 16*	waste blasting material containing hazardous substances
<b>17</b>	<b>CONSTRUCTION AND DEMOLITION WASTES (INCLUDING EXCAVATED SOIL FROM CONTAMINATED SITES)</b>
<b>17 01</b>	<b>concrete, bricks, tiles and ceramics</b>
17 01 06*	mixtures of, or separate fractions of concrete, bricks, tiles and ceramics containing hazardous substances
<b>17 05</b>	<b>soil (including excavated soil from contaminated sites), stones and dredging spoil</b>
17 05 03*	soil and stones containing hazardous substances
17 05 05*	dredging spoil containing hazardous substances
17 05 07*	track ballast containing hazardous substances
<b>19</b>	<b>WASTES FROM WASTE MANAGEMENT FACILITIES, OFF-SITE WASTE WATER TREATMENT PLANTS AND THE PREPARATION OF WATER INTENDED FOR HUMAN CONSUMPTION AND WATER FOR INDUSTRIAL USE</b>
<b>19 13</b>	<b>wastes from soil and groundwater remediation</b>
19 13 01*	solid wastes from soil remediation containing hazardous substances

<b>Table S2.2 Permitted waste types and quantities for hazardous road planings screening (Activity AR2)</b>	
<b>Maximum quantity</b>	Total amount of hazardous and non-hazardous waste to be treated is limited to 300 tonnes per day (combined total between activities authorised in Tables S2.1 and S2.2). Total amount of hazardous waste to be accepted annually is limited to 35,000 tonnes per year.
<b>Limits</b>	Wastes shall not have a noticeable smell of hydrocarbons, including petrol and oils.
<b>Waste code</b>	<b>Description</b>
<b>17</b>	<b>CONSTRUCTION AND DEMOLITION WASTES (INCLUDING EXCAVATED SOIL FROM CONTAMINATED SITES)</b>
<b>17 03</b>	<b>bituminous mixtures, coal tar and tarred products</b>
17 03 01*	bituminous mixtures containing coal tar

<b>Table S2.3 Permitted hazardous waste types and quantities for waste storage and transfer (Activity AR3)</b>	
<b>Maximum quantity</b>	Total amount of hazardous and non-hazardous waste to be stored prior to transfer is limited to 300 tonnes per day. Total amount of hazardous waste to be accepted annually is limited to 35,000 tonnes per year.
<b>Limits</b>	Wastes shall not have a noticeable smell of hydrocarbons, including petrol and oils.
<b>Waste code</b>	<b>Description</b>
<b>17</b>	<b>CONSTRUCTION AND DEMOLITION WASTES (INCLUDING EXCAVATED SOIL FROM CONTAMINATED SITES)</b>
<b>17 02</b>	<b>wood, glass and plastic</b>
17 02 04*	glass, plastic and wood containing or contaminated with hazardous substances

<b>Table S2.4 Permitted waste types and quantities for non-hazardous soil washing (Activity AR7)</b>	
<b>Maximum quantity</b>	Total amount of hazardous and non-hazardous waste to be treated is limited to 300 tonnes per day (combined total between activities authorised in Tables S2.1 and S2.2). Total amount of non-hazardous waste to be accepted annually is limited to 40,000 tonnes per year.
<b>Limits</b>	Wastes shall not have a noticeable smell of hydrocarbons, including petrol and oils.
<b>Waste code</b>	<b>Description</b>
<b>01</b>	<b>WASTES RESULTING FROM EXPLORATION, MINING, QUARRYING, AND PHYSICAL AND CHEMICAL TREATMENT OF MINERALS</b>
<b>01 04</b>	<b>wastes from physical and chemical processing of non-metalliferous minerals</b>
01 04 08	waste gravel and crushed rocks other than those mentioned in 01 04 07
01 04 09	waste sand and clays
01 04 13	wastes from stone cutting and sawing other than those mentioned in 01 04 07
<b>10</b>	<b>WASTES FROM THERMAL PROCESSES</b>
<b>10 01</b>	<b>waste from power stations and other combustion plants (except 19)</b>
10 01 24	sands from fluidised beds
<b>10 12</b>	<b>wastes from manufacture of ceramic goods, bricks, tiles and construction products</b>
10 12 08	wastes ceramics, bricks, tiles and construction products (after thermal processing)
<b>12</b>	<b>WASTES FROM SHAPING AND PHYSICAL AND MECHANICAL SURFACE TREATMENT OF METALS AND PLASTICS</b>
<b>12 01</b>	<b>waste from shaping and physical and mechanical surface treatment of metals and plastics</b>
12 01 17	waste blasting material other than those mentioned in 12 01 16
<b>17</b>	<b>CONSTRUCTION AND DEMOLITION WASTES (INCLUDING EXCAVATED SOIL FROM CONTAMINATED SITES)</b>
<b>17 05</b>	<b>soil (including excavated soil from contaminated sites), stones and dredging spoil</b>
17 05 04	soil and stones other than those mentioned in 17 05 03
17 05 06	dredging spoil other than those mentioned in 17 05 05
17 05 08	track ballast other than those mentioned in 17 05 07

<b>Table S2.4 Permitted waste types and quantities for non-hazardous soil washing (Activity AR7)</b>	
<b>Maximum quantity</b>	Total amount of hazardous and non-hazardous waste to be treated is limited to 300 tonnes per day (combined total between activities authorised in Tables S2.1 and S2.2). Total amount of non-hazardous waste to be accepted annually is limited to 40,000 tonnes per year.
<b>Limits</b>	Wastes shall not have a noticeable smell of hydrocarbons, including petrol and oils.
<b>Waste code</b>	<b>Description</b>
<b>19</b>	<b>WASTES FROM WASTE MANAGEMENT FACILITIES, OFF-SITE WASTE WATER TREATMENT PLANTS AND THE PREPARATION OF WATER INTENDED FOR HUMAN CONSUMPTION AND WATER FOR INDUSTRIAL USE</b>
<b>19 01</b>	<b>wastes from incineration or pyrolysis waste</b>
19 01 19	sands from fluidised beds
<b>19 08</b>	<b>wastes from waste water treatment plants not otherwise specified</b>
19 08 02	waste from desanding
<b>19 12</b>	<b>wastes from the mechanical treatment of waste (for example sorting, crushing, compacting, pelletising) not otherwise specified</b>
19 12 09	minerals (for example sand, stones)
<b>19 13</b>	<b>wastes from soil and groundwater remediation</b>
19 13 02	solid wastes from soil remediation other than those mentioned in 19 13 01
<b>20</b>	<b>MUNICIPAL WASTES (HOUSEHOLD WASTE AND SIMILAR COMMERCIAL, INDUSTRIAL AND INSTITUTIONAL WASTES) INCLUDING SEPARATELY COLLECTED FRACTIONS</b>
<b>20 02</b>	<b>garden and park wastes (including cemetery waste)</b>
20 02 02	soil and stones
<b>20 03</b>	<b>other municipal wastes</b>
20 03 03	street-cleaning residues

<b>Table S2.5 Permitted waste types and quantities for non-hazardous road planing screening (Activity AR7)</b>	
<b>Maximum quantity</b>	Total amount of hazardous and non-hazardous waste to be treated is limited to 300 tonnes per day (combined total between activities authorised in Tables S2.1 and S2.2). Total amount of non-hazardous waste to be accepted annually is limited to 40,000 tonnes per year.
<b>Limits</b>	Wastes shall not have a noticeable smell of hydrocarbons, including petrol and oils.
<b>Waste code</b>	<b>Description</b>
<b>17</b>	<b>CONSTRUCTION AND DEMOLITION WASTES (INCLUDING EXCAVATED SOIL FROM CONTAMINATED SITES)</b>
<b>17 03</b>	<b>bituminous mixtures, coal tar and tarred products</b>
17 03 02	bituminous mixtures other than those mentioned in 17 03 01

<b>Table S2.6 Permitted non-hazardous waste types and quantities for waste storage and transfer</b>	
<b>Maximum quantity</b>	Total amount of hazardous and non-hazardous waste to be stored prior to transfer is limited to 300 tonnes per day. Total amount of waste to be accepted onto the site for the activities in Tables S2.1, S2.2 and S2.3 is limited to 75,000 tonnes.
<b>Waste code</b>	<b>Description</b>
<b>17</b>	<b>CONSTRUCTION AND DEMOLATION WASTES (INCLUDING EXCAVATED SOIL FROM CONTAMINATED SITES)</b>
<b>17 01</b>	<b>concrete, bricks, tiles and ceramics</b>
17 01 01	concrete
17 01 02	bricks
17 01 03	tiles and ceramics
17 01 07	mixtures of concrete, bricks, tiles and ceramics other than those mentioned in 17 01 06
<b>17 02</b>	<b>wood, glass and plastic</b>
17 02 02	glass
<b>17 03</b>	<b>bituminous mixtures, coal tar and tarred products</b>
17 03 02	bituminous mixtures other than those mentioned in 17 03 01

## Schedule 3 – Emissions and monitoring

Table S3.1 Ambient air monitoring requirements						
Emission point ref. & location	Parameter	Source	Limit (incl. Unit)	Reference period	Monitoring frequency	Monitoring standard or method
Location 1 on “Schedule 7 – Site Plan”, submitted October 2015	Particulates	Wastes in storage area	200 mg m <sup>-2</sup> day <sup>-1</sup>	24-hours	Weekly	M17, BS 1747 Use directional dust deposit gauge.
Location 5 on “Schedule 7 – Site Plan”, submitted October 2015						
Location 2 & 6 on “Schedule 7 – Site Plan”, submitted October 2015	Particulates	Wastes in storage area	-	24-hours	Weekly	BS1747
Location 3 on “Schedule 7 – Site Plan”, submitted October 2015	Benzene	Wastes in storage area	1 ppm	24-hours	Daily	BS EN 14662-1:2005
Location 1 on “Schedule 7 – Site Plan”, submitted October 2015						
Location 2 & 4 on “Schedule 7 – Site Plan”, submitted October 2015	Benzene	Wastes in storage area	-	24-hours	Daily	BS EN 14662-1:2005

## Schedule 4 – Reporting

Parameters, for which reports shall be made, in accordance with conditions of this permit, are listed below.

<b>Table S4.1 Reporting of monitoring data</b>			
<b>Parameter</b>	<b>Emission or monitoring point/reference</b>	<b>Reporting period</b>	<b>Period begins</b>
Emissions to air Parameters as required by condition 3.3.1	Emission points as per table S3.1	Every 3 months	1 January, 1 April, 1 July, 1 October.

<b>Table S4.2: Annual production/treatment</b>	
<b>Parameter</b>	<b>Units</b>
Hazardous soil treated	tonnes
Non hazardous soil treated	tonnes
Hazardous road planings processed	tonnes
Non hazardous road planings processed	tonnes

<b>Table S4.3 Performance parameters</b>		
<b>Parameter</b>	<b>Frequency of assessment</b>	<b>Units</b>
Water usage	Annually	tonnes
Energy usage	Annually	MWh

<b>Table S4.4 Reporting forms</b>		
<b>Media/parameter</b>	<b>Reporting format</b>	<b>Date of form</b>
Air	Form air 1 or other form as agreed in writing by the Environment Agency	24/09/15
Water usage	Form water usage 1 or other form as agreed in writing by the Environment Agency	24/09/15
Energy usage	Form energy 1 or other form as agreed in writing by the Environment Agency	24/09/15
Other performance indicators	Form performance 1 or other form as agreed in writing by the Environment Agency	24/09/15

# Schedule 5 – Notification

These pages outline the information that the operator must provide.

Units of measurement used in information supplied under Part A and B requirements shall be appropriate to the circumstances of the emission. Where appropriate, a comparison should be made of actual emissions and authorised emission limits.

If any information is considered commercially confidential, it should be separated from non-confidential information, supplied on a separate sheet and accompanied by an application for commercial confidentiality under the provisions of the EP Regulations.

## Part A

Permit Number	
Name of operator	
Location of Facility	
Time and date of the detection	

<b>(a) Notification requirements for any malfunction, breakdown or failure of equipment or techniques, accident, or emission of a substance not controlled by an emission limit which has caused, is causing or may cause significant pollution</b>	
<b>To be notified within 24 hours of detection</b>	
Date and time of the event	
Reference or description of the location of the event	
Description of where any release into the environment took place	
Substances(s) potentially released	
Best estimate of the quantity or rate of release of substances	
Measures taken, or intended to be taken, to stop any emission	
Description of the failure or accident.	

<b>(b) Notification requirements for the breach of a limit</b>	
<b>To be notified within 24 hours of detection unless otherwise specified below</b>	
Emission point reference/ source	
Parameter(s)	
Limit	
Measured value and uncertainty	
Date and time of monitoring	

<b>(b) Notification requirements for the breach of a limit</b>	
<b>To be notified within 24 hours of detection unless otherwise specified below</b>	
Measures taken, or intended to be taken, to stop the emission	

<b>Time periods for notification following detection of a breach of a limit</b>	
<b>Parameter</b>	<b>Notification period</b>

<b>(c) Notification requirements for the detection of any significant adverse environmental effect</b>	
<b>To be notified within 24 hours of detection</b>	
Description of where the effect on the environment was detected	
Substances(s) detected	
Concentrations of substances detected	
Date of monitoring/sampling	

## Part B – to be submitted as soon as practicable

Any more accurate information on the matters for notification under Part A.	
Measures taken, or intended to be taken, to prevent a recurrence of the incident	
Measures taken, or intended to be taken, to rectify, limit or prevent any pollution of the environment which has been or may be caused by the emission	
The dates of any unauthorised emissions from the facility in the preceding 24 months.	

Name*	
Post	
Signature	
Date	

\* authorised to sign on behalf of the operator



## Schedule 6 – Interpretation

“accident” means an accident that may result in pollution.

“application” means the application for this permit, together with any additional information supplied by the operator as part of the application and any response to a notice served under Schedule 5 to the EP Regulations.

“authorised officer” means any person authorised by the Environment Agency under section 108(1) of The Environment Act 1995 to exercise, in accordance with the terms of any such authorisation, any power specified in section 108(4) of that Act.

“background concentration” means such concentration of that substance as is present in:

- for emissions to surface water, the surface water quality up-gradient of the site; or
- for emissions to sewer, the surface water quality up-gradient of the sewage treatment works discharge.

“disposal”. Means any of the operations provided for in Annex I to Directive 2008/98/EC of the European Parliament and of the Council on waste.

“emissions to land” includes emissions to groundwater.

“EP Regulations” means The Environmental Permitting (England and Wales) Regulations SI 2016 No.1154 and words and expressions used in this permit which are also used in the Regulations have the same meanings as in those Regulations.

“emissions of substances not controlled by emission limits” means emissions of substances to air, water or land from the activities, either from the emission points specified in schedule 3 or from other localised or diffuse sources, which are not controlled by an emission or background concentration limit.

“groundwater” means all water, which is below the surface of the ground in the saturation zone and in direct contact with the ground or subsoil.

“Hazardous property” has the meaning in Annex III of the Waste Framework Directive.

“Hazardous waste” has the meaning given in the Hazardous Waste (England and Wales) Regulations 2005 (as amended).

“Industrial Emissions Directive” means DIRECTIVE 2010/75/EU OF THE EUROPEAN PARLIAMENT AND OF THE COUNCIL of 24 November 2010 on industrial emissions

“List of Wastes” means the list of wastes established by Commission Decision 2000/532/EC replacing Decision 94/3/EC establishing a list of wastes pursuant to Article 1(a) of Council Directive 75/442/EEC on waste and Council Decision 94/904/EC establishing a list of hazardous waste pursuant to Article 1(4) of Council Directive 91/689/EEC on hazardous waste, as amended from time to time.

“MCERTS” means the Environment Agency’s Monitoring Certification Scheme.

Pests” means Birds, Vermin and Insects.

“quarter” means a calendar year quarter commencing on 1 January, 1 April, 1 July or 1 October.

“recovery” means any of the operations provided for in Annex II to Directive 2008/98/EC of the European Parliament and of the Council on waste.

“Waste code” means the six digit code referable to a type of waste in accordance with the List of Wastes and in relation to hazardous waste, includes the asterisk.

“Waste Framework Directive” or “WFD” means Waste Framework Directive 2008/98/EC of the European Parliament and of the Council on waste.

Where a minimum limit is set for any emission parameter, for example pH, reference to exceeding the limit shall mean that the parameter shall not be less than that limit.

Unless otherwise stated, any references in this permit to concentrations of substances in emissions into air means:

- in relation to emissions from non-combustion sources, the concentration at a temperature of 273K and at a pressure of 101.3 kPa, with no correction for water vapour content.

“year” means calendar year ending 31 December.

When the following terms appear in the waste code list in Schedule 2, table S2.1, S2.2 and S2.3, for those tables, they have the meaning given below:

“hazardous substance” means a substance classified as hazardous as a consequence of fulfilling the criteria laid down in parts 2 to 5 of Annex I to Regulation (EC) No 1272/2008.

# Schedule 7 – Site plan

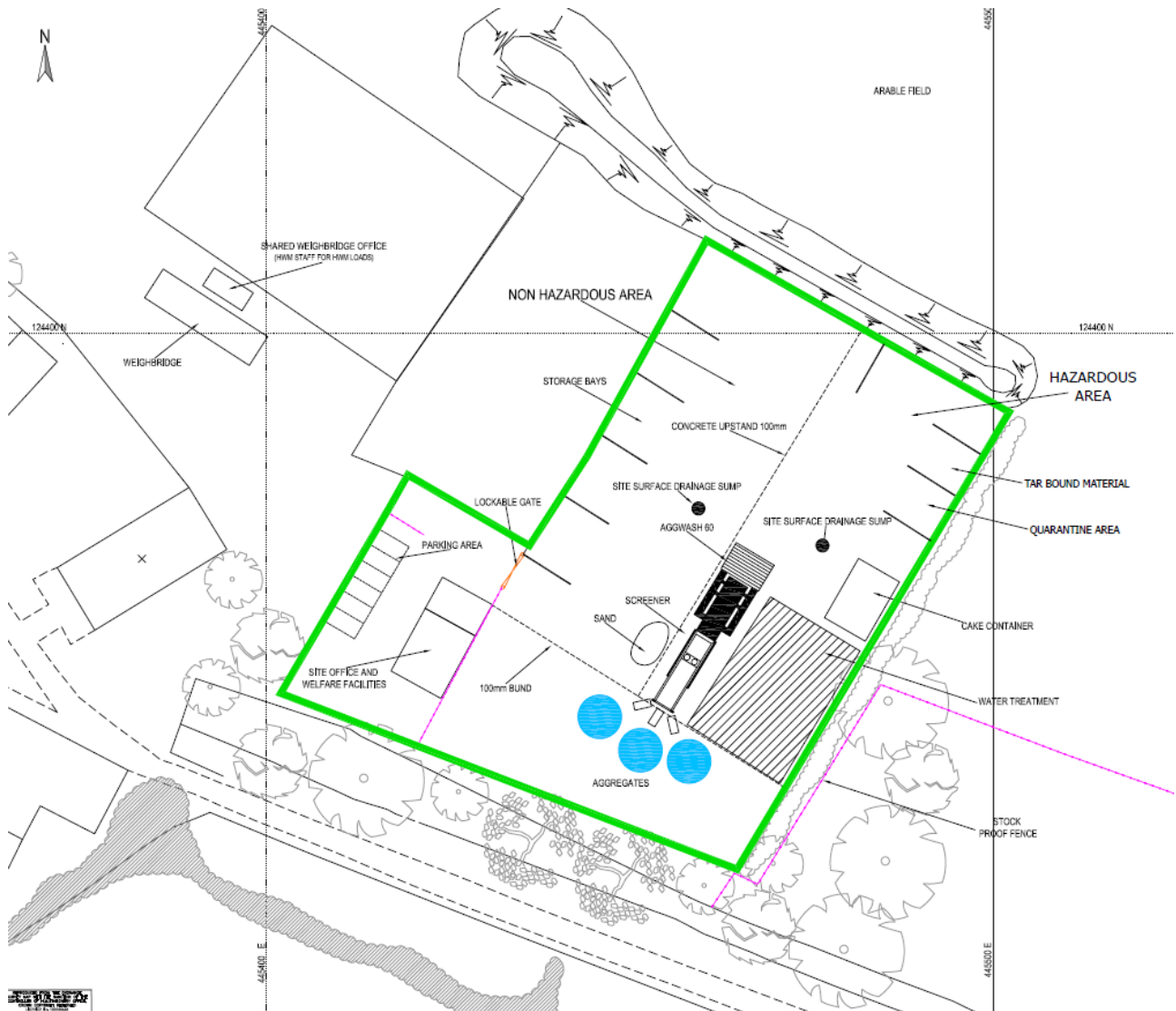

END OF PERMIT

**Permit Number:      EPR/JP3890VC**

**Operator:            Hazardous Waste Management Limited**

**Facility:             Four Dell Waste Management Facility**

**Form Number:        Air1 / 24/09/15**

**Reporting of emissions to air for the period from DD/MM/YYYY to DD/MM/YYYY**

<b>Emission Point</b>	<b>Substance / Parameter</b>	<b>Emission Limit Value</b>	<b>Reference Period</b>	<b>Result <sup>[1]</sup></b>	<b>Test Method <sup>[2]</sup></b>	<b>Sample Date and Times <sup>[3]</sup></b>	<b>Uncertainty <sup>[4]</sup></b>

1. The result given is the maximum value (or the minimum value in the case of a limit that is expressed as a minimum) obtained during the reporting period, expressed in the same terms as the emission limit value. Where the emission limit value is expressed as a range, the result is given as the ‘minimum – maximum’ measured values.
2. Where an internationally recognised standard test method is used the reference number is given. Where another method that has been formally agreed with the Environment Agency is used, then the appropriate identifier is given. In other cases the principal technique is stated, for example gas chromatography.
3. For non-continuous measurements the date and time of the sample that produced the result is given. For continuous measurements the percentage of the process operating time covered by the result is given.
4. The uncertainty associated with the quoted result at the 95% confidence interval, unless otherwise stated.

Signed .....

Date.....

(Authorised to sign as representative of Operator)

Permit Number: EPR/JP3890VC

Operator: Hazardous Waste Management Limited

Facility: Four Dell Waste Management Facility

Form Number: Water Usage1 / 24/09/15

### Reporting of Water Usage for the year YYYY

Emission Point	Substance / Parameter	Emission Limit Value	Reference Period	Result <sup>[1]</sup>	Test Method <sup>[2]</sup>	Sample Date and Times <sup>[3]</sup>	Uncertainty <sup>[4]</sup>

Operator's comments:

Signed .....

Date.....

(Authorised to sign as representative of Operator)

Permit Number: **EPR/JP3890VC**

Operator: **Hazardous Waste Management Limited**

Facility: **Four Dell Waste Management Facility**

Form Number: **Energy1 / 24/09/15**

### Reporting of Energy Usage for the year YYYY

Emission Point	Substance / Parameter	Emission Limit Value	Reference Period	Result <sup>[1]</sup>	Test Method <sup>[2]</sup>	Sample Date and Times <sup>[3]</sup>	Uncertainty <sup>[4]</sup>

Operator's comments:

Signed .....

Date.....

(Authorised to sign as representative of Operator)

**Permit Number:   EPR/JP3890VC**

**Operator:       Hazardous Waste Management Limited**

**Facility:        Four Dell Waste Management Facility**

**Form Number:   Performance1 / 24/09/15**

**Reporting of other performance indicators for the period DD/MM/YYYY to DD/MM/YYYY**

<b>Emission Point</b>	<b>Substance / Parameter</b>	<b>Emission Limit Value</b>	<b>Reference Period</b>	<b>Result <sup>[1]</sup></b>	<b>Test Method <sup>[2]</sup></b>	<b>Sample Date and Times <sup>[3]</sup></b>	<b>Uncertainty <sup>[4]</sup></b>

1. The result given is the maximum value (or the minimum value in the case of a limit that is expressed as a minimum) obtained during the reporting period, expressed in the same terms as the emission limit value. Where the emission limit value is expressed as a range, the result is given as the 'minimum – maximum' measured values.
2. Where an internationally recognised standard test method is used the reference number is given. Where another method that has been formally agreed with the Environment Agency is used, then the appropriate identifier is given. In other cases the principal technique is stated, for example gas chromatography.
3. For non-continuous measurements the date and time of the sample that produced the result is given. For continuous measurements the percentage of the process operating time covered by the result is given.
4. The uncertainty associated with the quoted result at the 95% confidence interval, unless otherwise stated.

Signed .....

Date.....

(Authorised to sign as representative of Operator)